

Rotary Step attenuators are used to adjust the power signal level by step within certain frequency range without power off, they can also be used to adjust the test system's power level as inset attenuators, it is small with high accuracy and high stability etc.

SATRXX-1-XX-X-A1 type rotary step attenuators' average power is 2W, 10W, frequency range from DC-6GHz, attenuation value 0-90dB by 0.1dB/ 1dB/ 10dB step.

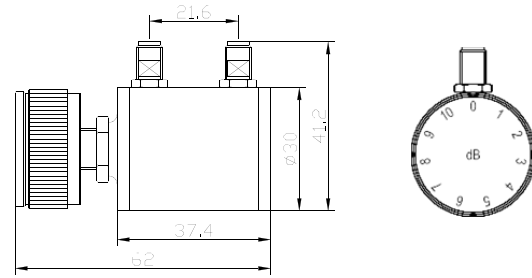

MECHANICAL SPECIFICATIONS	
Connectors	Brass Nickel Plated
Female Pin	Beryllium Copper Gold Plated
Housing	Brass Nickel Plated, Aluminum
Temp Range	-20°C~+85°C
Dimensions	Ø30×63mm(Without Connector)
Weight	250g

RoHS Compliant: Yes

ELECTRICAL SPECIFICATIONS

Model Number	Frequency Range(GHz)	Attenuation Step Size	Max VSWR	Insertion Loss(dB)	Attenuation Accuracy(dB)
SATRXX-1-1-2.5-A1	DC-2.5	0-1dB in 0.1dB steps	1.25	≤0.5	±0.2
SATRXX-1-1-3-A1	DC-3		1.30	≤0.5	±0.2
SATRXX-1-1-4.3-A1	DC-4.3		1.35	≤0.75	±0.3
SATRXX-1-1-6-A1	DC-6		1.50	≤1.0	±0.4
SATRXX-1-10-2.5-A1	DC-2.5	0-10dB in 1dB steps	1.25	≤0.4	±0.4
SATRXX-1-10-3-A1	DC-3		1.30	≤0.5	±0.5
SATRXX-1-10-4.3-A1	DC-4.3		1.35	≤0.75	±0.5
SATRXX-1-10-6-A1	DC-6		1.50	≤1.0	±0.5
SATRXX-1-60-2.5-A1	DC-2.5	0-60dB in 10dB steps	1.25	≤0.4	±0.5(<40dB) ±0.8 or ±3% (≥40dB)
SATRXX-1-60-3-A1	DC-3		1.30	≤0.5	
SATRXX-1-60-4.3-A1	DC-4.3		1.35	≤0.75	
SATRXX-1-60-6-A1	DC-6		1.50	≤1.0	
SATRXX-1-90-2.5-A1	DC-2.5	0-90dB in 10dB steps	1.25	≤0.4	±0.5(<40dB) ±0.8 or ±3% (≥40dB)
SATRXX-1-90-3-A1	DC-3		1.30	≤0.5	

Note: XX refer to Average Power in W

NOMINAL IMPEDANCE: 50Ω

AVERAGE POWER: 2W,10W

PEAK POWER: 100W(5μs pulse width with 2% duty cycle)

CONNECTOR TYPE: SMA(F,F); N(F,F)

Notes:

1. Dimensions Tolerance ±5%
2. Custom designs available for other special attenuation value & accuracy.