

SSMA coaxial fixed terminations absorb RF& microwave power and Suitable applications include radio base stations and other radio equipment, especially where high density connector population is required.

SSMA coaxial fixed termination's average power 2W, frequency range dc-18GHz and feature wide frequency band, low VSWR, excellent capacity in anti-pulse and anti-burnout.

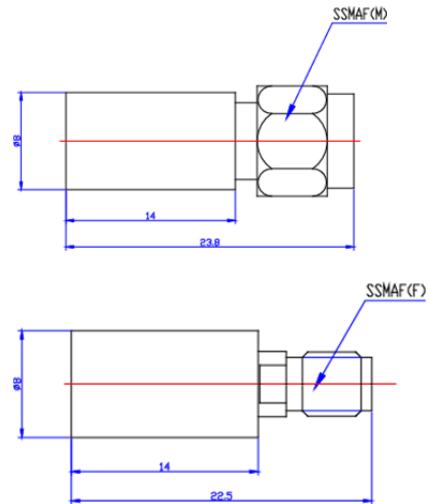

MECHANICAL SPECIFICATIONS	
Connectors	Brass Gold Plated
Male Pin	Brass Gold Plated
Female Pin	Beryllium Copper Gold Plated
Housing	Brass Nickel Plated
Temp Range	-55° C ~ +125° C
Dimensions	M:Ø8×23.8mm F: Ø8×22.5mm
Weight	M:5g F:5g

RoHS Compliant: Yes

ELECTRICAL SPECIFICATIONS

Model Number	Frequency Range(GHz)	Max VSWR	
		SSMA(M)	SSMA(F)
ST17XA-50-2W-08	DC-8	1.15	1.20
ST17XA-50-2W-12	DC-12.4	1.25	1.25
ST17XA-50-2W-18	DC-18	1.30	1.30

Note: X refer to connector Gender, 1 means Male, 2 means Female

NOMINAL IMPEDANCE: 50Ω

AVERAGE POWER: 2W average to 25°C ambient temperature, derated linearly to 0.2W @ 125°C

PEAK POWER: 0.25KW (5μs pulse width with 0.8% duty cycle)

CONNECTOR TYPE: SSMA

Notes:

1. Dimensions Tolerance ±5%
2. Custom designs available