

Coaxial fixed terminations absorb RF& microwave energy and are commonly used as dummy loads of antenna and transmitter. They are also used as match ports in many multiport microwave device such as circulator and directional coupler to make these ports which are not involved in the measurement be terminated in their characteristic impedance in order to ensure an accurate measurement.

N serial high power coaxial fixed termination's average power 2W-10KW, frequency range DC-18GHz and feature wide frequency band, low VSWR, excellent capacity in anti-pulse and anti-burnout.

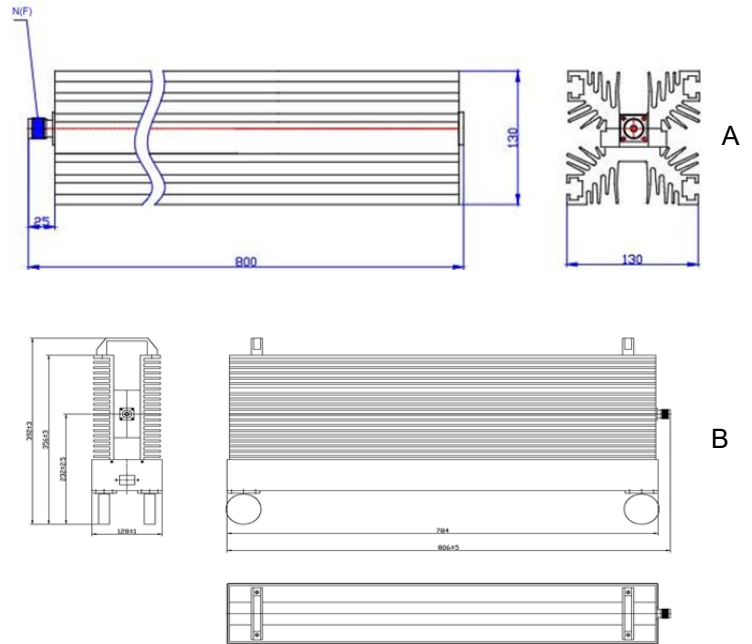

MECHANICAL SPECIFICATIONS	
Connectors	Brass Nickel Plated
Female Pin	Beryllium Copper Gold Plated
Housing	Aluminum,Black Anodize
Temp Range	-55° C ~ +125° C
Dimensions	A:800×130×130mm B:806×392×128mm
Weight	A:16Kg; B:27Kg

RoHS Compliant: Yes

ELECTRICAL SPECIFICATIONS

Model Number	Frequency Range (GHz)	Max VSWR
ST272B-50-1KW-02W	DC-2	1.20
ST272B-50-1KW-04W	DC-4	1.20
ST272B-50-1KW-06W	DC-6	1.30
ST272B-50-1KW-08W	DC-8	1.55

NOMINAL IMPEDANCE: 50Ω

AVERAGE POWER: 1000W average to 25°C ambient temperature, derated linearly to 100W @ 125°C

PEAK POWER: 5KW (5μs pulse width with 10% duty cycle)

CONNECTOR TYPE: N(F)

Notes:

1. Dimensions Tolerance ±5%
2. Custom designs available