

Reverse polarity coaxial termination is a variation of the standard SMA connector which reverses the polarity of the interface to female contact pins into the male connectors and male contact pins into the female connectors. RP SMA terminations are widely used by Wi-Fi and Wireless LAN equipment manufacturers to prevent consumers from connecting gain antennas to these systems.

RP SMA termination's average power 2W, frequency range DC-12.4GHz and feature wide frequency band, low VSWR, excellent capacity in anti-pulse and anti-burnout.

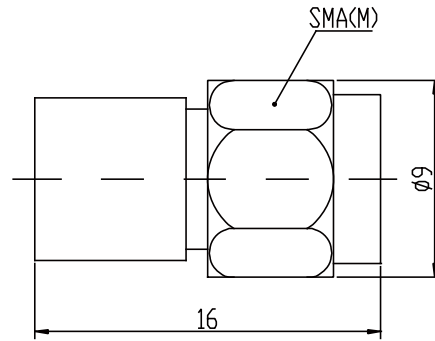

MECHANICAL SPECIFICATIONS	
Connectors	Brass Nickel Plated
Male Pin	Brass Gold Plated
Housing	Brass Nickel Plated
Temp Range	-55° C ~ +125° C
Dimensions	Ø9×16mm
Weight	5g

RoHS Compliant: Yes

#### ELECTRICAL SPECIFICATIONS

Model Number	Frequency Range (GHz)	Max VSWR
ST629B-50-2W-03	DC-3	1.15
ST629B-50-2W-06	DC-6	1.20
ST629B-50-2W-09	DC-9	1.20
ST629B-50-2W-12	DC-12.4	1.25

**NOMINAL IMPEDANCE:** 50Ω

**AVERAGE POWER:** 2W average to 25°C ambient temperature, derated linearly to 0.2W @ 125°C

**PEAK POWER:** 0.1KW(5μs pulse width with 2% duty cycle)

**CONNECTOR TYPE:** RP SMA(M) with female conductor

#### Notes:

1. Dimensions Tolerance ±5%
2. Custom designs available