

Inset terminations are used in quantitatively absorbing energy of RF and microwave system, they are commonly used as dummy loads of antenna and transmitter.

N serial wide-band Inset termination's average power from 50W-150W, frequency range from DC-18GHz and the features include wide frequency band, low VSWR, excellent capacity in anti-pulse and anti-burnout etc.

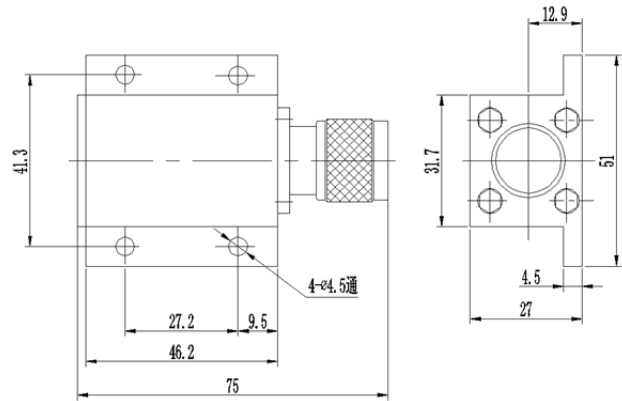

| MECHANICAL SPECIFICATIONS | |
|---------------------------|----------------------------------|
| Connectors | Brass Nickel Plated |
| Male Pin | Brass Gold Plated |
| Housing | Aluminum |
| Temp Range | -55° C ~ +125° C |
| Dimensions | 75×51×27mm 90×51×27mm(DC-18G) |
| Weight | 175g; 190g(DC-18G) |

RoHS Compliant: Yes

ELECTRICAL SPECIFICATIONS

| Model Number | Frequency Range (GHz) | Max VSWR |
|--------------------|-----------------------|----------|
| SNT271B-50-60W-03W | DC-3 | 1.10 |
| SNT271B-50-60W-06W | DC-6 | 1.20 |
| SNT271B-50-60W-08W | DC-8 | 1.25 |
| SNT271B-50-60W-10W | DC-10 | 1.35 |
| SNT271B-50-60W-18W | DC-18 | 1.55 |

NOMINAL IMPEDANCE: 50Ω

AVERAGE POWER: 60W average to 25°C ambient temperature, derated linearly to 5W @ 125°C

PEAK POWER: 10KW (5μs pulse width with 0.60% duty cycle)

CONNECTOR TYPE: N(M)

Notes:

1. Dimensions Tolerance ±5%
2. Custom designs available