

Inset terminations are used in quantitatively absorbing energy of RF and microwave system, they are commonly used as dummy loads of antenna and transmitter.

3.5mm inset termination's average power 10W, frequency range from DC-26.5GHz and the features include wide frequency band, low VSWR, excellent capacity in anti-pulse and anti-burnout etc.

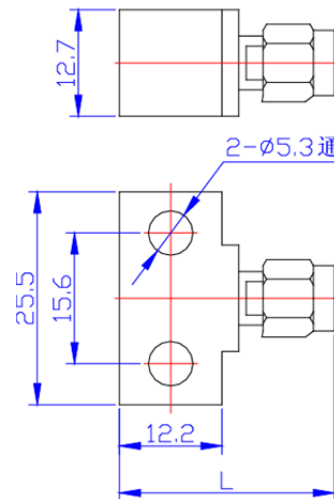

MECHANICAL SPECIFICATIONS	
Connectors	Stainless Steel Passivated
Male Pin	Brass Gold Plated
Female Pin	Beryllium Copper Gold Plated
Housing	Aluminum
Temp Range	-55° C ~ +125° C
Dimensions	M:26×25.5×12.7mm F:26×25.5×12.7mm
Weight	M:15g; F:10g

RoHS Compliant: Yes

ELECTRICAL SPECIFICATIONS

Model Number	Frequency Range (GHz)	Max VSWR
SNT39XD-50-10W-26	DC-26.5	1.30

Note: X refer to connector Gender, 1 means Male, 2 means Female

NOMINAL IMPEDANCE: 50Ω

AVERAGE POWER: 10W

CONNECTOR TYPE: 3.5mm

Notes:

1. Dimensions Tolerance $\pm 5\%$
2. Custom designs available