

Inset terminations are used in quantitatively absorbing energy of RF and microwave system, they are commonly used as dummy loads of antenna and transmitter.

N Inset termination's average power from 50W, frequency range from DC-4GHz and the features include wide frequency band, low VSWR, excellent capacity in anti-pulse and anti-burnout etc.

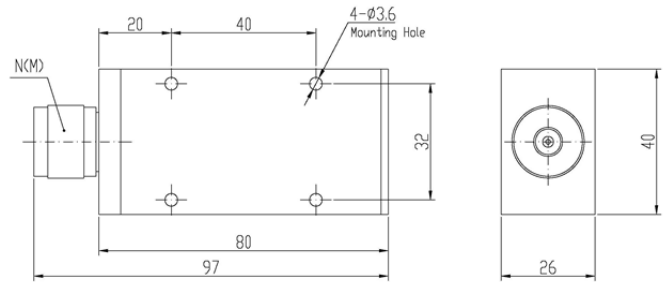

MECHANICAL SPECIFICATIONS	
Connectors	Brass Nickel Plated
Male Pin	Brass Gold Plated
Housing	Aluminum
Temp Range	-55° C ~ +125° C
Dimensions	97×40×26mm
Weight	220g

RoHS Compliant: Yes

#### ELECTRICAL SPECIFICATIONS

Model Number	Frequency Range (GHz)	Max VSWR
SNT271B-50-50W-01N	DC-1	1.15
SNT271B-50-50W-02N	DC-2	1.25
SNT271B-50-50W-04N	DC-4	1.30

**NOMINAL IMPEDANCE:** 50Ω

**AVERAGE POWER:** 50W average to 25°C ambient temperature, derated linearly to 5W @ 125°C

**PEAK POWER:** 10KW (5μs pulse width with 0.5% duty cycle)

**CONNECTOR TYPE:** N(M)

#### Notes:

1. Dimensions Tolerance ±5%
2. Custom designs available