

Electrical Specifications ($T_A = +25^\circ\text{C}$)

Parameter	Specification	Unit
Suitable Frequency	11.9-18.0	GHz
Relative Bandwidth	6%	-
Insertion Loss	≤ 0.3	dB
Isolation	≥ 20	dB
VSWR	$\leq 1.2:1$	--
Operating Temperature	-40 to +85	$^\circ\text{C}$
Peak Power	1000	W
Duty Cycle	10%	-
Connector Type	WR62	

Outline Drawing

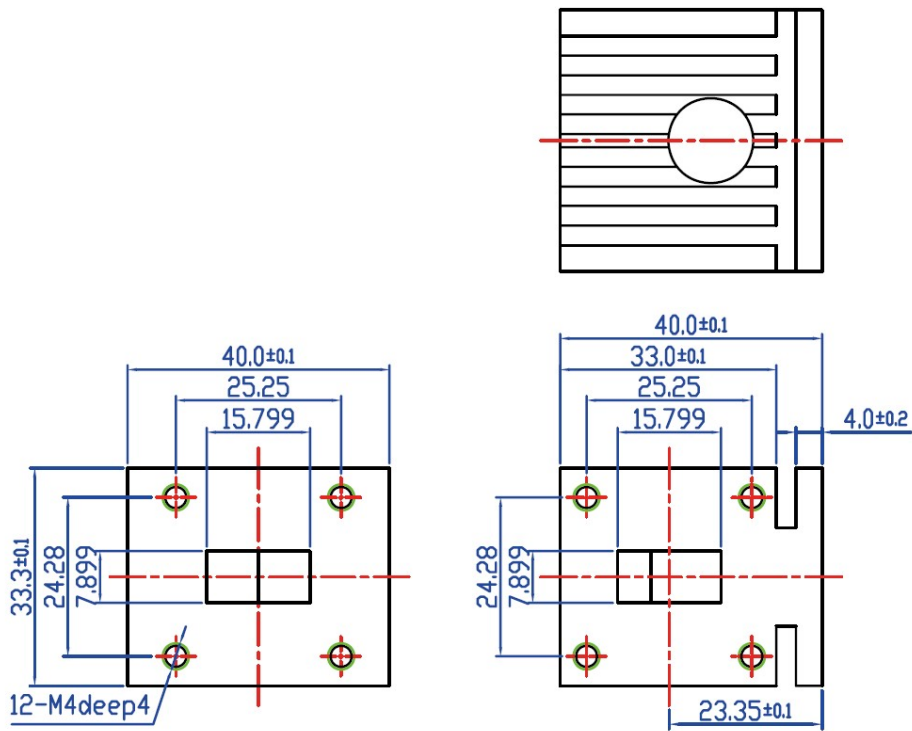

Unit: mm