

Electrical Specifications ($T_A = +25^\circ\text{C}$)

Parameter	Specification	Unit
Suitable Frequency	60.5-92.0	GHz
Relative Bandwidth	1%	-
Insertion Loss	≤ 0.8	dB
Isolation	≥ 18	dB
VSWR	1.3:1	--
Operating Temperature	-40 to +85	$^\circ\text{C}$
Connector Type	WR12	

Outline Drawing

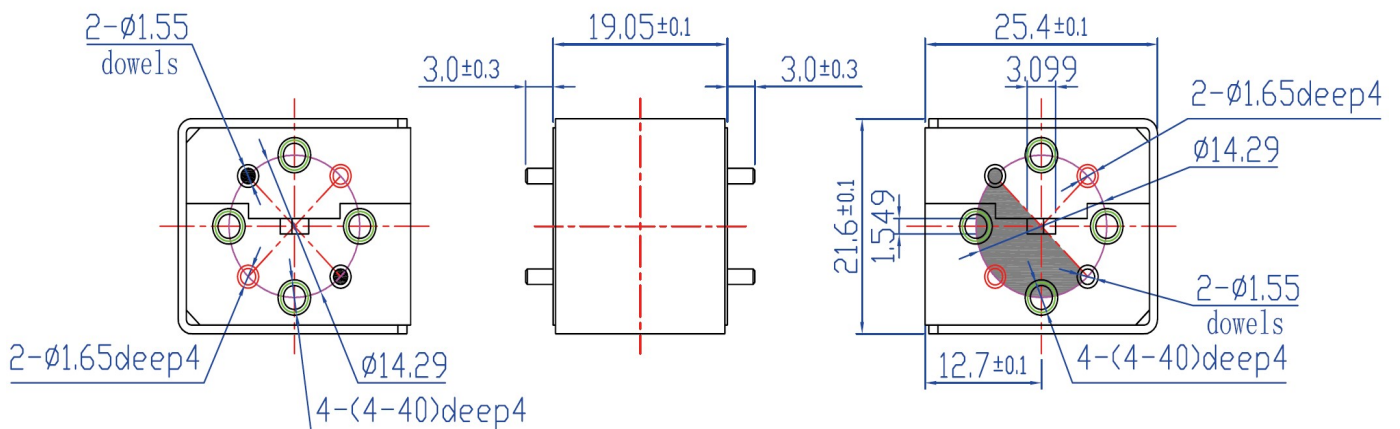

Unit: mm