

Electrical Specifications ($T_A = +25^\circ\text{C}$)

| Parameter | Specification | Unit |
|-----------------------|---------------|------------------|
| Suitable Frequency | 9.48-15.0 | GHz |
| Relative Bandwidth | 5% | - |
| Insertion Loss | ≤ 0.3 | dB |
| Isolation | ≥ 20 | dB |
| VSWR | $\leq 1.2:1$ | -- |
| Operating Temperature | -40 to +85 | $^\circ\text{C}$ |
| Connector Type | WR75 | |

Outline Drawing

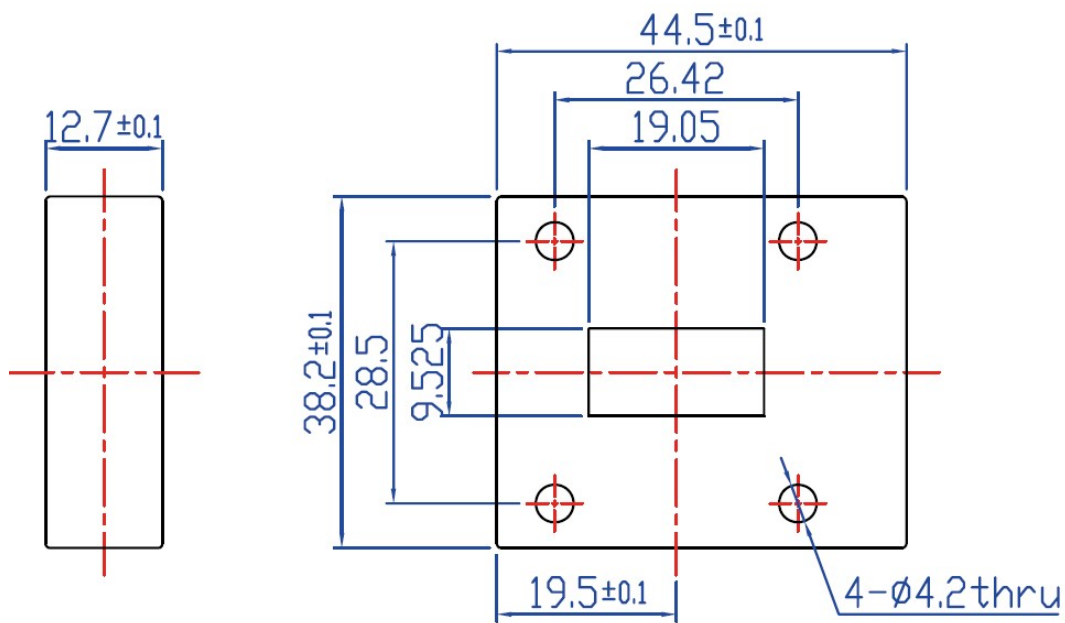

Unit: mm