

Coaxial fixed attenuators are used in absorbing energy of transmission line, expanding power range and controlling power level, they are also used in accurately measuring power or spectrum of RF microwave transmitters accompany with small power meter, comprehensive tester or spectrum analyzer.

SMA serial coaxial fixed attenuators' average power 2W, frequency range from DC-18GHz and feature wide frequency band, low VSWR, flatness attenuation value and excellent capacity in anti-pulse and anti-burnout etc.



1-12dB



> 12dB

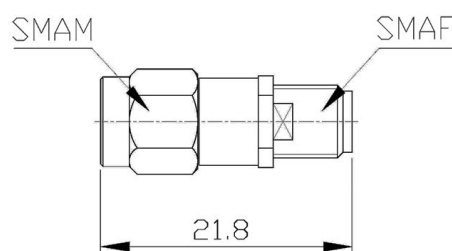

1-12dB

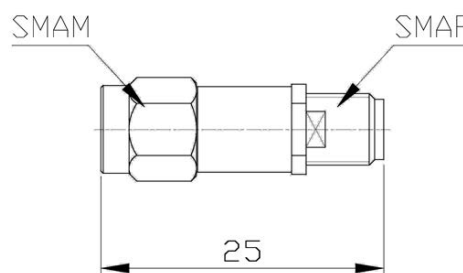

> 12dB

MECHANICAL SPECIFICATIONS	
Connectors	Stainless Steel Passivated
Male Pin	Brass Gold Plated
Female Pin	Beryllium Copper Gold Plated
Housing	Aluminum
Temp Range	-55° C ~ +125° C
Dimensions	S8×21.8mm (1-12)dB S8×25mm (>12)dB
Weight	4g (1-12)dB; 5g (>12)dB

RoHS Compliant: Yes

## ELECTRICAL SPECIFICATIONS

Model Number	Frequency Range(GHz)	Attenuation Value & Accuracy (dB)						Max VSWR
		1-9	10	12	15	20	30	
SAT18D02XX06M	DC-6	±0.5	±0.5	±0.5	±0.5	±0.5	±0.5	1.15
SAT18D02XX08M	DC-8	±0.5	±0.5	±0.5	±0.5	±0.5	±0.5	1.25
SAT18D02XX12M	DC-12.4	-0.5/+0.8	-0.5/+0.8	-0.5/+0.8	-0.5/+0.8	-0.5/+0.8	-0.5/+0.8	1.30
SAT18D02XX18M	DC-18	-0.5/+1.0	±0.8	±0.8	±0.8	±0.8	±0.8	1.30

Note: XX refer to attenuation value in dB

**NOMINAL IMPEDANCE:** 50Ω

**AVERAGE POWER:** 2W average to 25°C ambient temperature, derated linearly to 0.5W @ 125°C.

**PEAK POWER:** 0.5KW (5μs pulse width with 0.4% duty cycle)

**CONNECTOR TYPE:** SMA

## Notes:

1. Dimensions Tolerance ±5%
2. Custom designs available for other special attenuation value & accuracy.